

- Sizes :** 1" to 6" Nominal Bore
- Pressure:** ANSI Class 600 lbs
- Features:**
- Integrally cast housing
 - Quick-release closure
 - Red oxide finish (Carbon Steel only)
 - Ø 3 mm perforated hole plate as standard
 - Integral feet on 6"
- Advantages:**
- Tool-free opening and cleaning
 - Largest filtration area on the market
 - Very low pressure losses dp
 - Extended cleaning intervals
 - European design
- Options:**
- Special baskets and special gaskets
 - Safety Interlock Closure
 - DP tappings / gauge
 - Magnetic basket insert
 - Flanged drains / drain valves
 - Screwed and plugged NPT-Vent
 - Special finish / linings
 - Bolted Closure
- Standards:** PED 2014/68/EU
ANSI B16.5 Flange dimensions
EN 10204 / NACE Certification

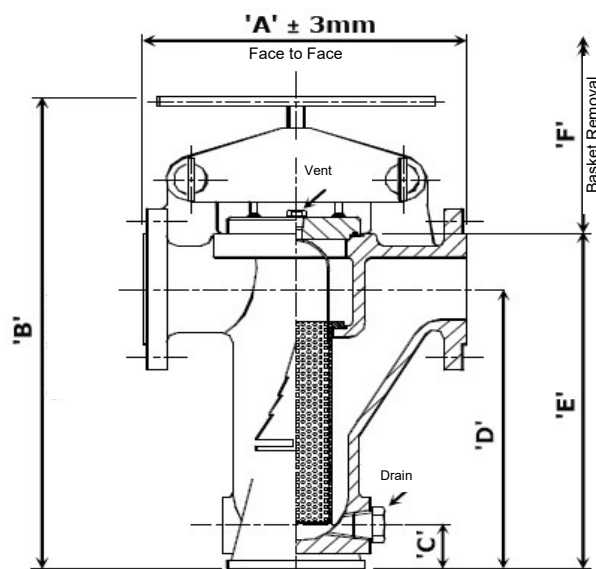

All data is subject to confirmation at the time of order. Our policy is one of continual improvement and we reserve the right to amend details without prior notice.

Technical Data

Size		Dimensions						Basket Area [cm ²]	Vent (NPT optional / BSPP for Safety Closure)		Drain (NPT)	Weight (kg)
mm	Inch	A	B	C	D	E	F		NPT	BSPP		
25	1"	265,0	365,0	30,0	192,0	242,0	225,0	233,0	¼"	⅛"	½"	22,0
40	1½"	305,0	445,0	30,0	255,0	316,0	290,0	368,0	¼"	⅛"	½"	32,0
50	2"	370,0	515,0	48,0	320,0	386,0	360,0	478,0	¼"	⅛"	½"	44,0
80	3"	440,0	610,0	66,0	357,0	442,0	390,0	641,0	¼"	⅛"	½"	74,0
100	4"	540,0	740,0	66,0	442,0	542,0	470,0	1061,0	⅜"	¼"	½"	138,0
150	6"	800,0	1065,0	85,0	650,0	796,0	650,0	2120,0	½"	½"	1"	338,0

Materials of Construction

Item	Low Temperature Carbon Steel	Stainless Steel
Strainer body (cast)	ASTM A352 LCB/LCC *	ASTM A351 CF8M (~1.4408)
Strainer cover	ASTM A352 LCB/LCC *	ASTM A240 316 / A351 CF8M
Strainer basket	Stainless Steel 316 (Ø 3 mm perforated hole plate as standard / to customer specification)	
Cover gasket (RJ)	Viton as standard / to customer specification	
Vent plug	ASTM A350 LF2	ASTM A182 F316 (~1.4404)
Drain plug	ASTM A350 LF2	ASTM A182 F316 (~1.4404)
Strongback	ASTM A352 LCB/LCC *	ASTM A351 CF8M (~1.4408)
Screw handle	ASTM A193 B7M – zinc plated / ST.ST. handle	
Quick release pin	ASTM A193 B7 - Zinc Plated	
Linch pin	Carbon steel – zinc plated	

* Dual certified material as per ASME VIII – Division 1, UG23(a).

Model Number Derivation : **A***/R60/***/MQR**

Size, i.e. add 025 for a 1"

352 for L.T. carbon steel (A352 LCB/LCC)
351 for stainless steel (A351 CF8M)