

- Sizes :** 2" to 24"
- Pressure:** ANSI 150 lbs
- Flanges:** ASME B16.5
- Features:**
- Fabricated construction
  - Bolted cover c/w drain plug
  - Red oxide finish (Carbon Steel only)
  - Ø 3 mm perforated hole plate as standard
  - Full NDE (X-Ray/MPI/DPI)
  - Schedule STD wall thickness as standard
  - Industry standard 'V'-Sieve design
- Options:**
- Special body & cover material
  - Special Gasket and Bolting Material
  - Special sieve materials / perforated plates
  - Mesh lines of sieves
  - 'W' sieve design for increased filter area
  - 'W' sieve design for reduced pressure loss
  - Alternative flange specification
  - Alternative schedule / wall thickness
  - Plugged / flanged drain connection
  - Special finish / painting / lining
  - Hydrostatic pressure testing
- Standards:** PED 2014/68/EC  
 CE-Marking  
 EN 10204-3.1  
 NACE MR-01-75  
 ISO 15156

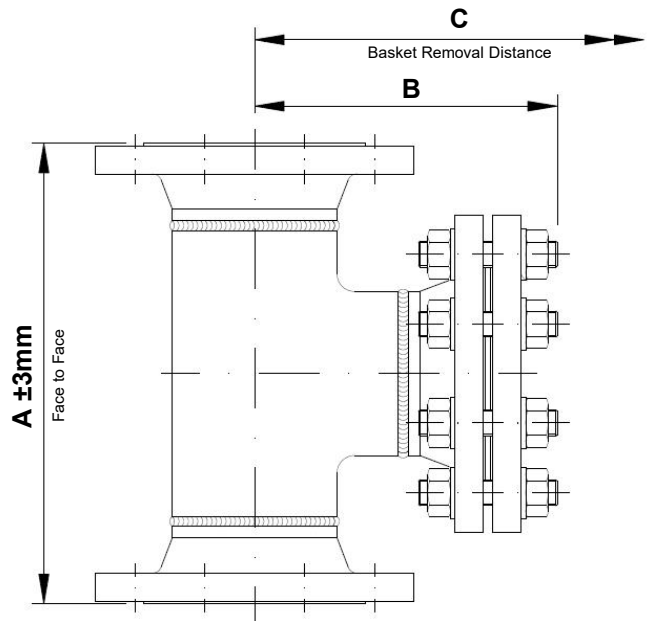

All data is subject to confirmation at the time of order. Our policy is one of continual improvement and we reserve the right to amend details without prior notice.

### Technical Data

Size		Dimensions [mm]			Weight	Size		Dimensions [mm]			Weight
mm	inch	A	B	C	appr. [kg]	mm	inch	A	B	C	appr. [kg]
50	2"	258	164	307	16,0	300	12"	740	422	926	230,0
80	3"	316	200	381	29,0	350	14"	817	467	1021	307,0
100	4"	366	225	443	36,0	400	16"	868	495	1101	393,0
150	6"	468	277	572	62,0	450	18"	970	571	1200	468,0
200	8"	563	329	696	104,0	500	20"	1055	616	1300	570,0
250	10"	640	370	799	156,0	600	24"	1173	667	1500	805,0

### Materials of Construction

Item	LT Carbon Steel	Carbon Steel	Stainless Steel
Equal Tee	ASTM A420 WPL6	ASTM A234 WPB	ASTM A403 WP316
Weld Neck Flange	ASTM A350 LF2	ASTM A105N	ASTM A182 F316
Strainer Cover	ASTM A350 LF2	ASTM A105N	ASTM A182 F316
Drain Plug (forged)*	ASTM A350 LF2	ASTM A105N	ASTM A182 F316
Cover Stud Bolts	ASTM A320 L7M – zinc plated	ASTM A193 B7M – zinc plated	
Cover Full Nuts	ASTM A194 Gr.7M – zinc plated	ASTM A194 2HM – zinc plated	
Cover Washer	Carbon steel – zinc plated		
Cover Gasket (flat)	C.N.A.F. as standard / to customer specification		
Screen (perforated)	SS 316 (~1.4401) (Ø 3 mm perforated hole plate as standard / to customer specification )		

\*optionally

**Model Number Derivation:**

A\*\*\*/R15/\*\*\*/FTFL

Denotes the size, i.e. add '050' for a 2"

- 105 for Carbon Steel
- 182 for Stainless Steel
- 350 for Low Temperature Carbon Steel