

- Sizes :** 2" to 24"
- Pressure:** ANSI 300 lbs
- Flanges:** ASME B16.5
- Features:**
- Fabricated construction
 - Bolted cover c/w drain plug
 - Red oxide finish (Carbon Steel only)
 - Ø 3 mm perforated hole plate as standard
 - Full NDE (X-Ray/MPI/DPI)
 - Schedule STD wall thickness as standard
 - Industry standard 'V'-Sieve design
- Options:**
- Special body & cover material
 - Special Gasket and Bolting Material
 - Special sieve materials / perforated plates
 - Mesh lines of sieves
 - 'W' sieve design for increased filter area
 - 'W' sieve design for reduced pressure loss
 - Alternative flange specification
 - Alternative schedule / wall thickness
 - Plugged / flanged drain connection
 - Special finish / painting / lining
 - Hydrostatic pressure testing
- Standards:** PED 2014/68/EC
 CE-Marking
 EN 10204-3.1
 NACE MR-01-75
 ISO 15156

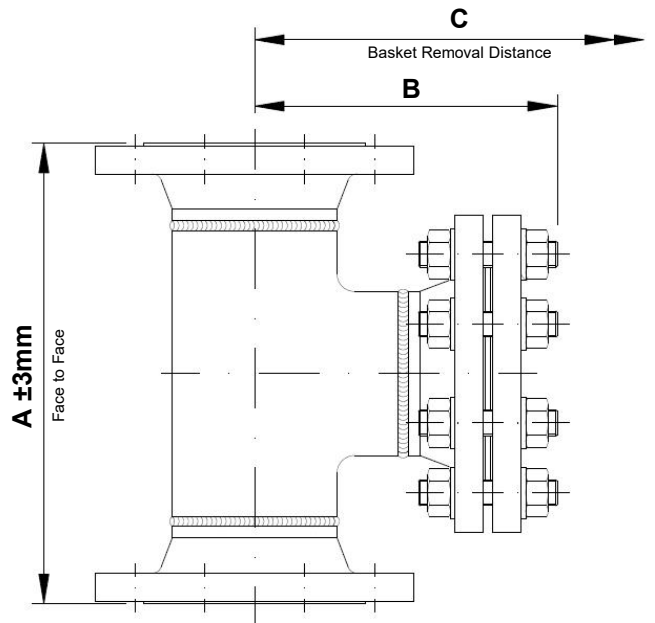

All data is subject to confirmation at the time of order. Our policy is one of continual improvement and we reserve the right to amend details without prior notice.

Size		Dimensions [mm]			Weight
mm	inch	A	B	C	appr.. [kg]
50	2"	270	175	320	19,0
80	3"	335	215	405	44,0
100	4"	385	245	470	60,0
150	6"	486	300	605	98,0
200	8"	585	355	730	167,0
250	10"	670	410	850	242,0

Size		Dimensions [mm]			Weight
mm	inch	A	B	C	appr. [kg]
300	12"	772	465	980	356,0
350	14"	850	505	1075	478,0
400	16"	905	540	1160	618,0
450	18"	1010	620	1220	742,0
500	20"	1090	625	1320	912,0
600	24"	1205	630	1520	1291,0

1/1

Materials of Construction

Item	LT Carbon Steel	Carbon Steel	Stainless Steel
Equal Tee	ASTM A420 WPL6	ASTM A234 WPB	ASTM A403 WP316
Weld Neck Flange	ASTM A350 LF2	ASTM A105N	ASTM A182 F316
Strainer Cover	ASTM A350 LF2	ASTM A105N	ASTM A182 F316
Drain Plug (forged)*	ASTM A350 LF2	ASTM A105N	ASTM A182 F316
Cover Stud Bolts	ASTM A320 L7M – zinc plated	ASTM A193 B7M – zinc plated	
Cover Full Nuts	ASTM A194 Gr.7M – zinc plated	ASTM A194 2HM – zinc plated	
Cover Washer	Carbon steel – zinc plated		
Cover Gasket (flat)	C.N.A.F. as standard / to customer specification		
Screen (perforated)	SS 316 (~1.4401) (Ø 3 mm perforated hole plate as standard / to customer specification)		

*optionally

Model Number Derivation:

A*/R30/***/FTFL**

Denotes the size, i.e. add '050' for a 2"

105 for Carbon Steel
 182 for Stainless Steel
 350 for Low Temperature Carbon Steel