

- Sizes :** 2" to 24"
- Pressure:** ANSI 600 lbs
- Flanges:** ASME B16.5
- Features:**
- Fabricated construction
  - Bolted cover c/w drain plug
  - Red oxide finish (Carbon Steel only)
  - Ø 3 mm perforated hole plate as standard
  - Full NDE (X-Ray/MPI/DPI)
  - Schedule XS wall thickness as standard
  - Industry standard 'V'-Sieve design
- Options:**
- Special body & cover material
  - Special Gasket and Bolting Material
  - Special sieve materials / perforated plates
  - Mesh lines of sieves
  - 'W' sieve design for increased filter area
  - 'W' sieve design for reduced pressure loss
  - Alternative flange specification
  - Alternative schedule / wall thickness
  - Plugged / flanged drain connection
  - Special finish / painting / lining
  - Hydrostatic pressure testing
- Standards:** PED 2014/68/EC  
CE-Marking  
EN 10204-3.1  
NACE MR-01-75  
ISO 15156

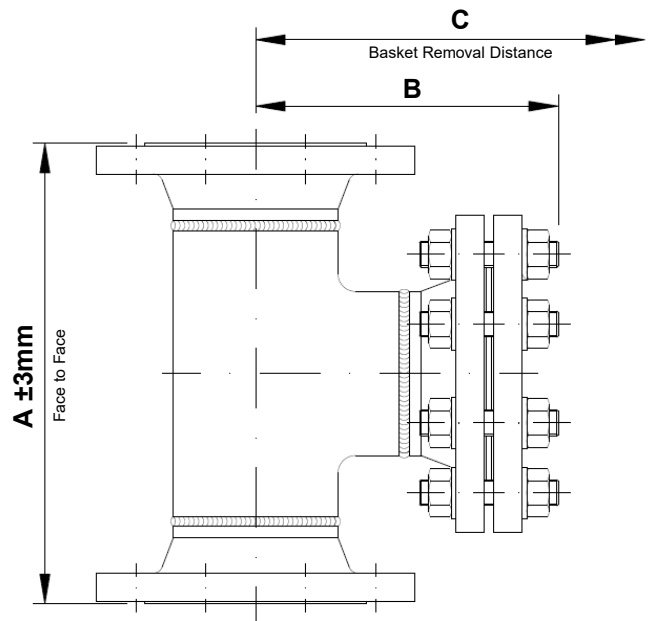

All data is subject to confirmation at the time of order. Our policy is one of continual improvement and we reserve the right to amend details without prior notice.

Size		Dimensions [mm]			Weight
mm	inch	A	B	C	appr. [kg]
50	2"	290	175	320	34,0
80	3"	355	215	405	68,0
100	4"	430	245	470	122,0
150	6"	538	300	605	240,0
200	8"	640	355	730	361,0
250	10"	755	410	850	590,0

Size		Dimensions [mm]			Weight
mm	inch	A	B	C	appr. [kg]
300	12"	835	465	980	746,0
350	14"	907	505	1075	1046,0
400	16"	985	540	1160	1430,0
450	18"	1075	620	1220	1780,0
500	20"	1060	625	1320	2160,0
600	24"	1290	630	1520	3025,0

1/1

### Materials of Construction

Item	LT Carbon Steel	Carbon Steel	Stainless Steel
Equal Tee	ASTM A420 WPL6	ASTM A234 WPB	ASTM A403 WP316
Weld Neck Flange	ASTM A350 LF2	ASTM A105N	ASTM A182 F316
Strainer Cover	ASTM A350 LF2	ASTM A105N	ASTM A182 F316
Drain Plug (forged)*	ASTM A350 LF2	ASTM A105N	ASTM A182 F316
Cover Stud Bolts	ASTM A320 L7M – zinc plated	ASTM A193 B7M – zinc plated	
Cover Full Nuts	ASTM A194 Gr.7M – zinc plated	ASTM A194 2HM – zinc plated	
Cover Washer	Carbon steel – zinc plated		
Cover Gasket (flat)	Spiral Wound ST.ST. 316 / Graphite (as Standard / to Customer Specification)		
Screen (perforated)	SS 316 (~1.4401) (Ø 3 mm perforated hole plate as standard / to customer specification)		

\*optionally

#### Model Number Derivation:

**A\*\*\*/R60/\*\*\*/FTFL**

Denotes the size, i.e. add '050' for a 2"

105 for Carbon Steel  
182 for Stainless Steel  
350 for Low Temperature Carbon Steel