

- Sizes :** 2" to 24"
- Pressure:** ANSI 900 lbs
- Flanges:** ASME B16.5
- Features:**
- Fabricated construction
  - Bolted cover c/w drain plug
  - Red oxide finish (Carbon Steel only)
  - Ø 3 mm perforated hole plate as standard
  - Full NDE (X-Ray/MPI/DPI)
  - Schedule STD wall thickness as standard
  - Industry standard 'V'-Sieve design
- Options:**
- Special body & cover material
  - Special Gasket and Bolting Material
  - Special sieve materials / perforated plates
  - Mesh lines of sieves
  - 'W' sieve design for increased filter area
  - 'W' sieve design for reduced pressure loss
  - Alternative flange specification
  - Alternative schedule / wall thickness
  - Plugged / flanged drain connection
  - Special finish / painting / lining
  - Hydrostatic pressure testing
- Standards:** PED 2014/68/EC  
CE-Marking  
EN 10204-3.1  
NACE MR-01-75  
ISO 15156

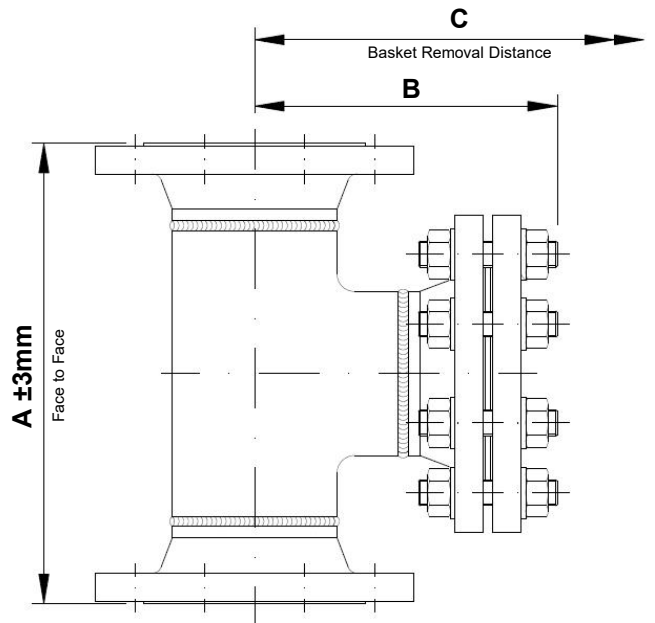

All data is subject to confirmation at the time of order. Our policy is one of continual improvement and we reserve the right to amend details without prior notice.

Size		Dimensions [mm]			Weight
mm	inch	A	B	C	appr. [kg]
50	2"	347	175	320	58,0
80	3"	392	215	405	88,0
100	4"	455	245	470	142,0
150	6"	585	300	605	300,0
200	8"	698	355	730	488,0
250	10"	820	410	850	740,0

Size		Dimensions [mm]			Weight
mm	inch	A	B	C	appr. [kg]
300	12"	925	465	980	994,0
350	14"	1005	505	1075	1405,0
400	16"	1060	540	1160	2050,0
450	18"	1160	620	1220	2400,0
500	20"	1275	625	1320	2930,0
600	24"	1465	630	1520	4986,0

1/1

### Materials of Construction

Item	LT Carbon Steel	Carbon Steel	Stainless Steel
Equal Tee	ASTM A420 WPL6	ASTM A234 WPB	ASTM A403 WP316
Weld Neck Flange	ASTM A350 LF2	ASTM A105N	ASTM A182 F316
Strainer Cover	ASTM A350 LF2	ASTM A105N	ASTM A182 F316
Drain Plug (forged)*	ASTM A350 LF2	ASTM A105N	ASTM A182 F316
Cover Stud Bolts	ASTM A320 L7M – zinc plated	ASTM A193 B7M – zinc plated	
Cover Full Nuts	ASTM A194 Gr.7M – zinc plated	ASTM A194 2HM – zinc plated	
Cover Washer	Carbon steel – zinc plated		
Cover Gasket (flat)	Spiral Wound ST.ST. 316 / Graphite (as Standard / to Customer Specification)		
Screen (perforated)	SS 316 (~1.4401) (Ø 3 mm perforated hole plate as standard / to customer specification)		

\*optionally

**Model Number Derivation:**

**A\*\*\* / R90 / \*\*\* / FTFL**

Denotes the size, i.e. add '050' for a 2"

105 for Carbon Steel  
182 for Stainless Steel  
350 for Low Temperature Carbon Steel